

EN - Warning

Improper installation will result in damage to the processor. Never switch the computer system on until the cooler and the fans are connected to the motherboard power connector.

Always use the included screws. Screw the radiator with care to avoid damaging it.

Electrostatic discharge (ESD) can damage system components. Use an ESD-controlled workstation. If a workstation is not available, wear an antistatic wrist strap or touch an earthed surface before handling any PC components.

Components description

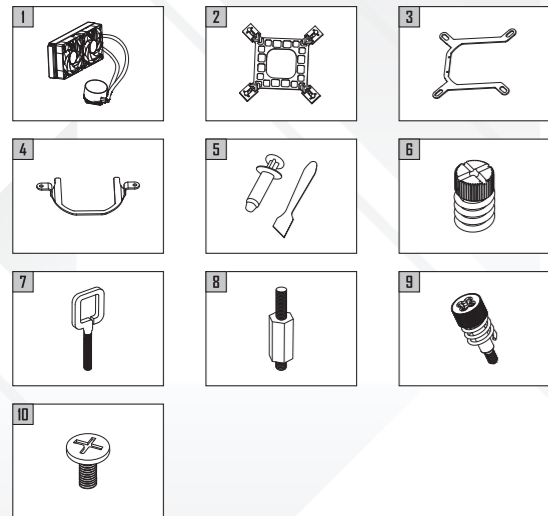

- 1) CPU Cooler
- 2) Intel Backplate
- 3) Intel Bracket
- 4) AMD Bracket
- 5) Thermal Paste
- 6) Screw (x4)
- 7) AMD Screw Stud (x2)
- 8) Intel Screw Stud (x4)
- 9) 2011 Screw Stud (x4)
- 10) Case Screws
240 (x8)
360 (x12)

Backplate mounting holes illustration

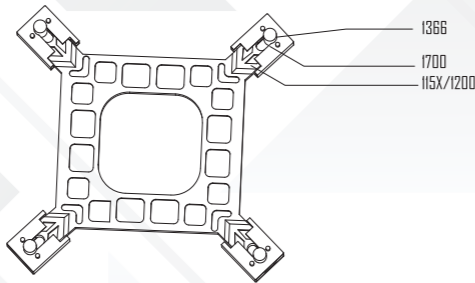

Intel mounting

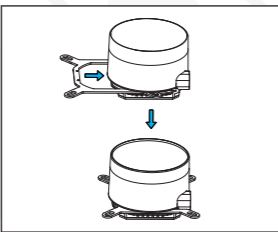

Intel bracket mounting

Installing the Intel / AMD bracke

* Intel bracket is universal for LGA2066 / 2011 / 1150 / 1151 / 1155 / 1156 / 1366

Intel mounting: LGA1150 / 1151 / 1155 / 1156 / 1366 / 1200 installation

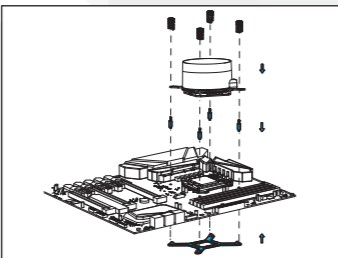

continues in next page >

Secure the cooler -Intel L GA 115X /1200/1700

comes from previous page >

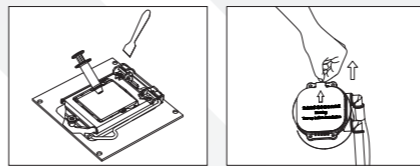

Applying thermal paste

Remove the protection film

Intel mounting: LGA2066 / 2011 installation

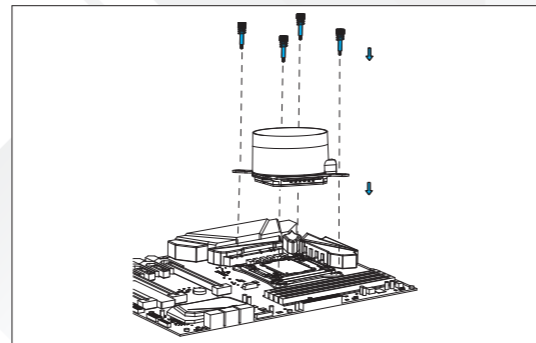

AMD mounting

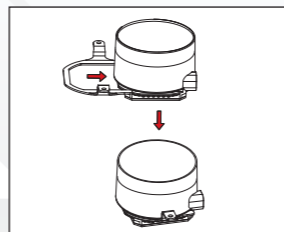

AMD bracket mounting

Installing the AMD bracke

* AMD bracket is universal for TR4 / AM4 / AM5 / FM2(+) / FM1 / AM3(+) / AM2(+)

AMD mounting: AM4 / AM5 / FM2(+)/ FM1 / AM3(+)/ AM2(+) installation

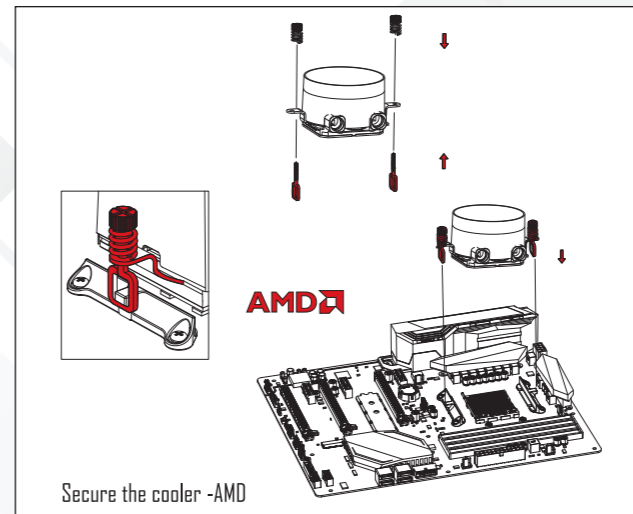

Fan & radiator mounting

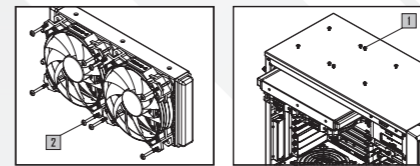

Use the fan mounting screws to secure the fan(s) onto the radiator.

Use the radiator mounting screws to secure the radiator to the case panel.

ARGB lighting connection guide

CAUTION!
Wrong connection will damage the device and cause malfunction!

Connection through motherboard RGB control

A) Download RGB Sync software compatible with your motherboard from its manufacturer's official website to adjust RGB color / mode.

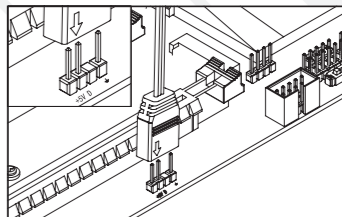

ASUS: ADD_HEADER

MSI: JRAINBOW

GIGABYTE: D_LED

ASROCK: ADDR_LED

B) Use RGB Splitter to Connect Pump / Fans' RGB Cables.

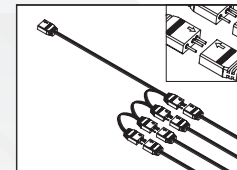

part of:

